

**New**

# Signal Tower & USB



Ease of use to innovate  
production sites.

---

## Powered over USB

---

Control and supply electricity  
with one cable.

\* The USB cable is not included with this product.



---

## Uses a software library

---

PC controlled.



The optimal solution unique to the FA field is a USB connection

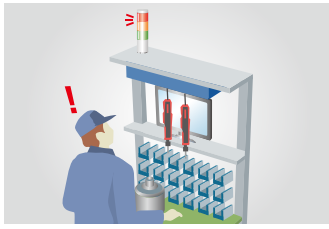

**Production Line**  
Error notification without a PLC.



**Interface with equipment**  
Display the status condition of PC controlled units, such as a printer.

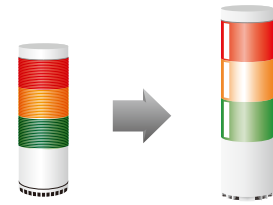

**Compatible with PATLITE's LU7-USB Model**  
PATLITE's LU7-USB software is also compatible. No need to make program corrections.

Uses a software library

- The use of a software library (downloadable from our website), makes controlling it simple.
- Download a demo application and sample code from our website.

No need for exclusive driver installations

- Installing an exclusive driver is unnecessary because it is supported in the HID device class.

The optimal solution unique to the FA field is a USB connection

- A variety of attachment options are available.

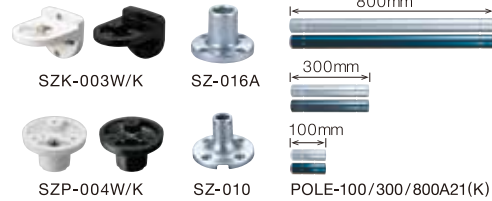

\* For details of optional items etc., come visit our website.

Specifications

Model	LR6-3USB□-RYG	LR6-USB□
Rated Voltage	5V DC (USB bus power)	
Operating Voltage Range	Rated voltage ±5% *Compliant with USB2.0 standard	
Rated Current Consumption	500mA (max)	
Ambient Operating Temperature	-20°C to +50°C	
Ambient Operating Humidity	90% RH or less, no condensation	
Mounting location / direction	Indoors / Upright	
Protection Rating	IP65 (IEC 60529), NEMA TYPE 4X,13 * Except when using pole bracket or wall bracket.	
Mass(Tolerance: ±10%)	320g	140g
LED unit control	Light on, pattern on (4 types)	
Buzzer	Operation	Sound on, sound pattern (4 types)
	Frequency	13 types
	Sound pressure	Typ.80dB (1m from the front of the buzzer aperture / at 2349.3 Hz), Sound reduction (Buzzer switch: Low): approximately -10dB
Communication method	USB2.0 Full Speed	
Software Library (DLL) Supported OS	Windows®7, Windows®8 (excluding Windows®8 RT), Windows®8.1 (excluding Windows®8.1RT), Windows®10	

Model Number Configuration

LR6-□USB□-RYG

Signal Tower Tiers: Blank : Body Unit, 3 : 3 Tiers  
Body Color: W : Off-white, K : Black  
LED Unit Color: Blank : Body Unit, RYG : Red, Amber, Green (From top to bottom)

Supported LED Unit



- The maximum number of LED unit attachments for LR6-E-□ and LR6-E-□Z, is five in total.
- No units other than the supported LED units are compatible.
- Two or more LED units of the same color for LR6-E-□ and LR6-E-□Z are not connectable.
- No other units are connectable for the LR6-E-MZ.
- There are two kind of patterns when lighting the LR6-E-MZ.

Outer Dimensional Drawing

■ LR6-3USB□-RYG

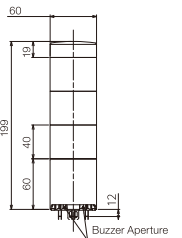

■ LR6-USB□

LED unit Qty.	L
0	79
1	119
2	159
3	199
4	239
5	279

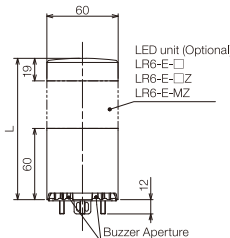

■ Mounting Dimensional Drawing

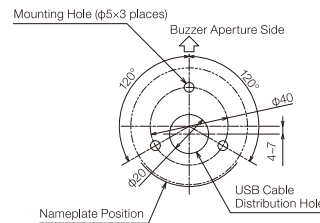

■ Applicable USB Cable Dimensions

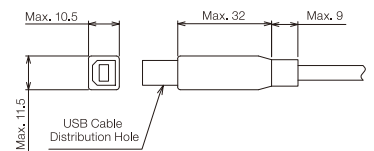

**PATLITE Corporation**

4-1-3, Kyutaromachi, Chuo-ku, Osaka 541-0056 Japan  
International Sales Division  
TEL.+81-6-7711-8953 FAX.+81-6-7711-8961 E-mail: overseas@patlite.co.jp

**PATLITE (U.S.A.) Corporation**

20130 S. Western Ave. Torrance, CA 90501, U.S.A.  
TEL.+1-310-328-3222 FAX.+1-310-328-2676 E-mail: sales@patlite.com

**PATLITE (SINGAPORE) PTE LTD**

No.2 Leng Kee Road, #05-01 Thye Hong Centre, Singapore 159086  
TEL.+65-6226-1111 FAX.+65-6324-1411 E-mail: sales@patlite.com.sg

**PATLITE (CHINA) Corporation**

Room 1102-1103, No.55, Lane 777, Guangzhong Road (West), Zhabei District, Shanghai, China 200072  
TEL.+86-21-6630-8969 FAX.+86-21-6630-8938 E-mail: sales@patlite.cn

**PATLITE Europe GmbH**

Am Soeldnermoos 8, D-85399 Hallbergmoos, Germany  
TEL.+49-811-9981-9770-0 FAX.+49-811-9981-9770-90 E-mail: info@patlite.eu

**PATLITE KOREA CO., LTD.**

A-2603, Daesung D-POLIS, 606, Seobusaet-gil, Geumcheon-gu, Seoul, 08504, Korea  
TEL.+82-2-523-6636 FAX.+82-2-861-9919 E-mail: sales@patlite.co.kr

**PATLITE TAIWAN CO., LTD.**

7F, No. 91, Huayin St, Datong District Taipei, Taiwan R.O.C  
TEL.+886-2-2555-1611 FAX.+886-2-2555-1621 E-mail: info@patlite.tw

**PATLITE (THAILAND) CO., LTD.**

Olympia Thai Tower, 15th Floor 444 Ratchadapisek Road Samsenok, Huay Kwang Bangkok 10310, Thailand  
TEL.+66-2-541-5431 FAX.+66-2-541-5429 E-mail: sales@patlite.co.th

**CAUTION**

To ensure correct use of these products, read the "Instruction Manual" prior to use. Failure to follow all safeguards can result in fire, electric shock, or other accidents. Specifications are subject to change without notice.



**PATLITE ECO PROJECT**

For the benefit of mankind and the earth, Patlite is committed to developing environmentally friendly products.

O-AH02 EN 1804 A

<http://www.patlite.com>

● PATLITE, the PATLITE logo are either registered trademarks or trademarks of PATLITE Corporation in JAPAN and/or other countries.